

# the bridal suite

Situated in the Castle's south wing the suite offers a haven of calm, with private access and exceptional views of the parkland to the front of the Castle.

To prepare or stay on your wedding night will make the experience of being married at Thirlestane Castle even more memorable, ensuring long and happy memories of the most important day in the life of any couple.

## LOUNGE

Deep armchairs and sofa  
Sattelite television  
Internet connection  
Discreet full kitchen facilities

## BATHROOM

Free standing bath  
Shower  
Heated towel rails  
Seating

## BEDROOM

King size bed  
Original dressing table, chest  
of drawers and wardrobes  
Seating

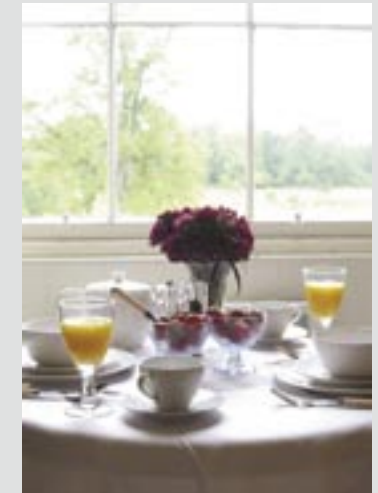
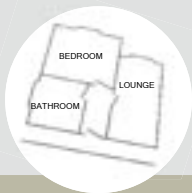

## PRIVACY, CHAMPAGNE & LUXURY

Available also for short breaks, weekends away or just for the sheer splendour of it.

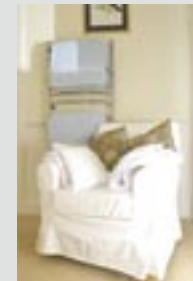

# Terms & Conditions

**Accommodation:** The property hired is strictly on the basis that the accommodation is for holiday use only and that no right to remain in the accommodation exists for the hirer and/or person allowed into the property by him/her. The hirer will be liable for costs incurred as a result of delayed departure.

**Holiday Price:** A full balance of the total amount is payable not less than 4 weeks before arrival.

**Deposit:** A deposit of 20% of the total should be sent with the booking form.

**Cancellation:** In the event of a cancellation, the hirer must advise immediately. Once monies have been paid, this is forfeited should the holiday be cancelled.

**Cleanliness, loss and damage:** The hirer is expected to leave the accommodation as found on arrival, and to pay for any losses or breakages.

**Non-availability of the property:** If for any reason beyond the Owner's control the property is not available on the date booked, all rents and charges paid in advance by the Applicants will be refunded in full, but the Applicants shall have no further claim against the Owners.

**Number of persons:** This accommodation is for 2 people and has a single bedroom with double bed. No pets or children allowed.

**No Smoking:** Due to the historic value of the property any smoking or fires are strictly forbidden.

## To book contact:

Mr Ian I.D. Garner  
Thirlestane Castle  
Lauder  
Berwickshire TD2 6RU

Tel. +44(0)1578 722 430  
Fax. +44(0)1578 722 761  
Email. [enquiries@thirlestanecastle.co.uk](mailto:enquiries@thirlestanecastle.co.uk)

*A deposit of 20% should be paid on booking, with the balance due 4 weeks prior to your holiday.*

*The prices include all electric and heating, bed linen and towels. The rental starts at 2pm on the arrival date and you are asked to vacate by 10am on the departure date.*

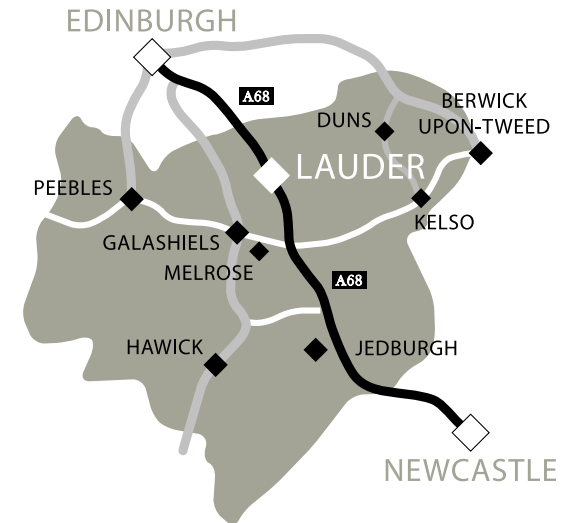

## Distances

Edinburgh Airport	34 miles
Glasgow Airport	80 miles
Newcastle Upon-Tyne Airport	71 miles
Manchester Airport	199 miles
London, Heathrow Airport	369 miles

A more detailed location map and directions can be provided upon request.



## Thirlestane Castle Trust

A Scottish Registered Charity

Thirlestane Castle Lauder TD2 6RU  
Tel. +44(0)1578 722 430  
Fax. +44(0)1578 722 761  
e-mail. [admin@thirlestanecastle.co.uk](mailto:admin@thirlestanecastle.co.uk)  
website. [www.thirlestanecastle.co.uk](http://www.thirlestanecastle.co.uk)



## Trustees:

Mr Neil R Hynd Esq, LVO FRIAS FSA Scot (Chairman); Captain The Hon G E I Maitland-Carew LL; Major Alexander R Trotter LL; Captain David J Bowes-Lyon DL; IHB Cathie BA(Hons) Esq; The Hon Mrs Mary Coltman; Mr Edward I C Maitland-Carew Esq; Mr Harry Robertson Esq; Mrs R Weaver

## Castle Administrator:

Mr. Ian I D Garner